

## M6061 ROTARY VALVE ACTUATORS

### PRODUCT DATA

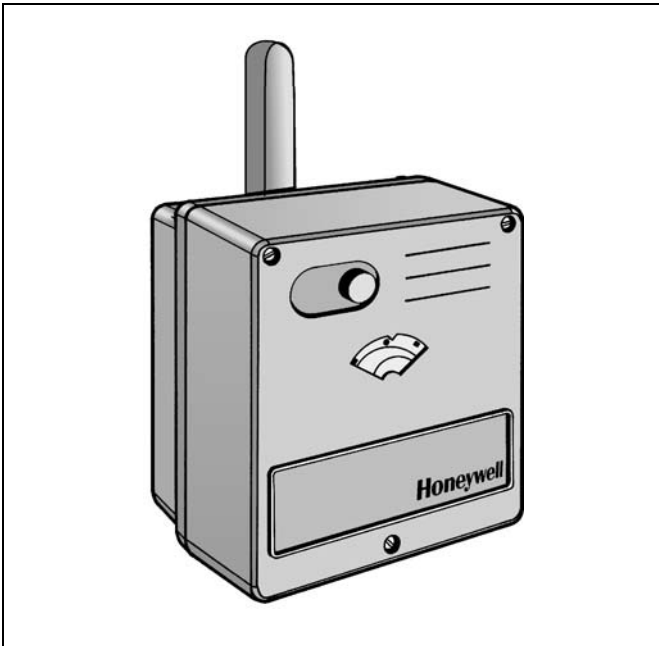

### Features

- Protected against overload and blocking
- Maintenance-free electrical actuator for rotary valves
- Clear position indicator
- Direct mounting on rotary valves
- Manual operation
- High torque
- Large wiring cabinet
- Long lifetime

### Specifications

Power supply	230 Vac / 24 Vac; 50 Hz Depending on type
Power consumption	3.5 VA
Control signal	230 Vac / 24 Vac, floating. Depending on type (see table)
Run time	Depending on type (see table)
Nominal torque	10 Nm / 20 Nm / 30 Nm / 40 Nm. Depending on type (see table)
Angle of rotation	90°
Protection standard	IP 54 per EN 60529
Insulation class	II per EN 60730
Ambient temperature for operation	0 to 60 °C
Water temperatures in the valve	2 to 130 °C
Relative humidity	Non-condensing
Weight	1.5 kg

### Application

The Honeywell M6061 actuator is designed to provide floating control in heating and air conditioning systems. High control performance and a robust design are standard for this actuator. In combination with the valve V5431, it is possible to control very exact heating and cooling water temperatures. The mechanical interface between actuator and valve is designed for reliable operation. Actuators with torques from 10 Nm up to 40 Nm are available for a wide range of rotary mixing valves (DIN 15 up to DIN 150).

### Specification per Actuator

torque [NM]	order no. actuator 24Vac floating	order no. actuator 230Vac floating	run time [min/90°]
10	M6061A1013	M6061L1019	1.5
20	M6061A1021	M6061L1027	1.6
30	M6061A1039	M6061L1035	2.3
40	M6061A1047	M6061L1043	3.5

## Suitable Valves

V5431A; V5431F

## Mounting on the Valve

Before mounting the actuator, position the rotary valve according to its installation instruction.

## Operation

The actuator is powered by a synchronous motor. The spindle of the actuator rotates 90°. In the end positions the motor is switched off by end switches.

Manual operation declutches the gear from the valve. As soon the actuator is powered, the valve is driven by the actuator again.

There is no adjustment necessary. The actuator is maintenance-free.

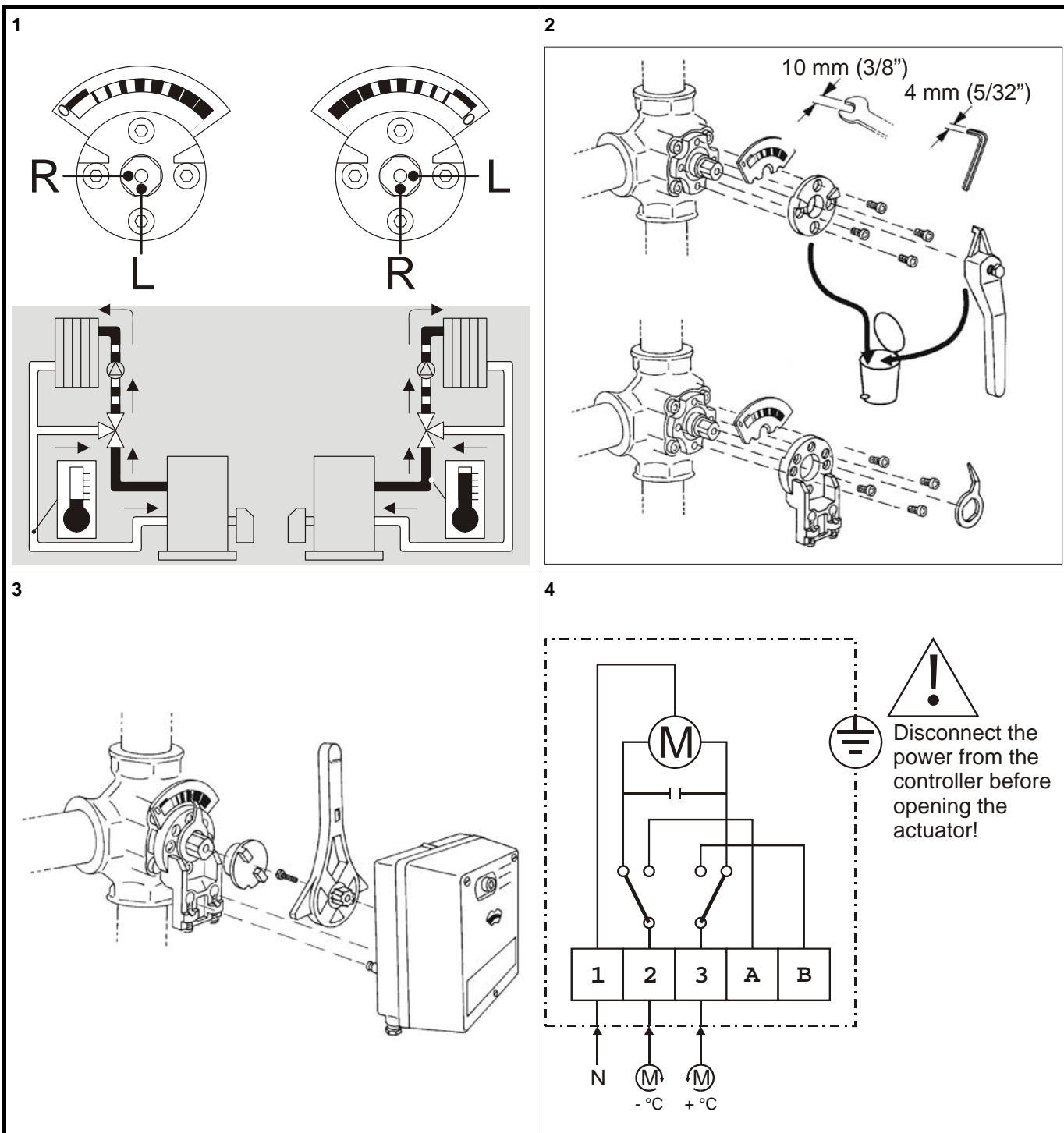

## Dimensions (mm)

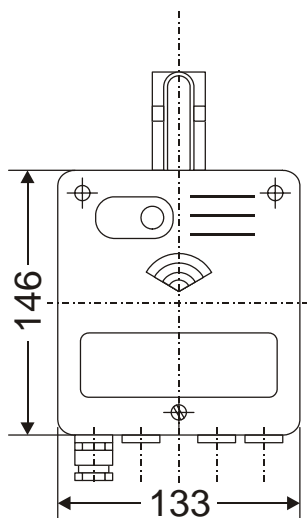

## Dimensions with V5431A (mm)

Type	DN	a	c	SW	h	i
V5431A1025	15	110	179	41	55	R ½ in.
V5431A1033	20	110	179	46	55	R ¾ in.
V5431A1041	25	115	179	50	58	R 1 in.
V5431A1058	32	140	188	60	70	R 1 ¼ in.
V5431A1066	40	150	188	65	75	R 1 ½ in.

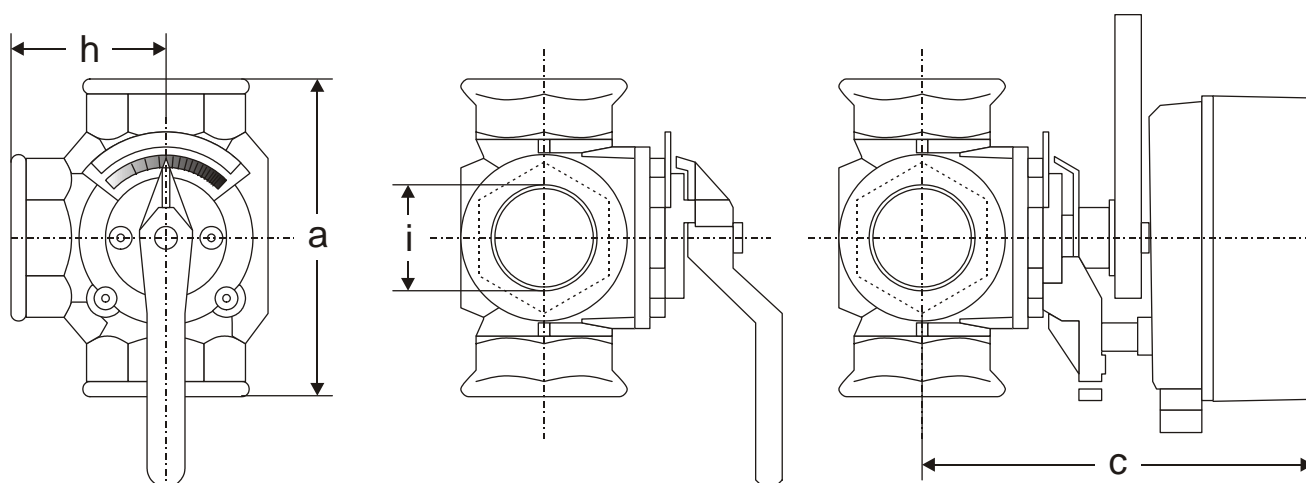

## Dimensions with V5431F (mm)

Type	DN	a	b	c	d	e	f	g	h
V5431F1032	20	140	15	179	65	90	50	4x11	70
V5431F1040	25	150	15	179	75	100	60	4x11	75
V5431F1057	32	160	17	188	90	120	70	4x14	80
V5431F1065	40	170	16	188	100	130	80	4x14	85
V5431F1073	50	190	16	202	110	140	90	4x14	95
V5431F1081	65	210	16	219	130	160	110	4x14	105
V5431F1099	80	250	18	219	150	190	128	4x18	125
V5431F1107	100	270	18	240	170	210	148	4x18	135
V5431F1115	125	310	20	267	200	240	178	8x18	155
V5431F1123	150	330	20	274	225	265	202	8x18	165

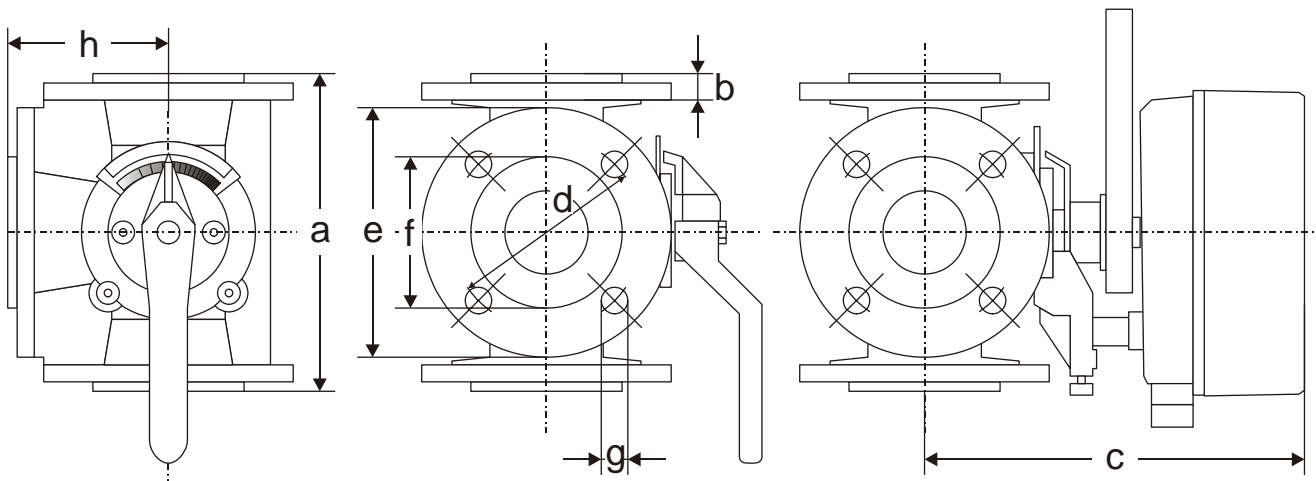

# Honeywell

Manufactured for and on behalf of the Environmental and Combustion Controls Division of Honeywell Technologies Sàrl, Ecublens, Route du Bois 37, Switzerland by its Authorized Representative:

### Automation and Control Solutions

Honeywell GmbH  
 Böblinger Straße 17  
 D-71101 Schönaich / Germany  
 Phone: (49) 7031 637 - 01  
 Fax: (49) 7031 637 - 493  
<http://europe.hbc.honeywell.com>

**DIN EN ISO**  
**9001/14001**

Subject to change without notice. Printed in Germany

EN0B-0075GE51 R0306